

**Section 1**

**General Description**

The CP/TX radio transmitter provides reliable wireless activation of any automatic door. This single device provides 3 selectable frequencies: High Definition Radio Control™ (HDRC™), 300 MHz and 390 MHz.

High Definition Radio Control™ is the latest breakthrough in radio frequency (RF) signal transmission. Unlike conventional RF systems in use today, HDRC™ uses a sophisticated component that transmits a fixed frequency signal that does not distort due to outside interference. This fixed signal is then transmitted through a proprietary "electronic filter" in the receiver ensuring door activation occurs. For added versatility, the CP/TX includes the two most widely used conventional frequencies, 300 MHz and 390 MHz. A simple slide switch allows the CP/TX to be used interchangeably with all past MS SEDCO products and competitor's products utilizing these frequencies.

**Section 2**

**Basic Installation**

- 1) Remove the mounting box back plate, drill at least two holes and secure in its intended location.
- 2) **SELECT FREQUENCY:** Select the desired frequency, via the 3-position slide switch, on the transmitter circuit board (Fig. 1). HDRC™ is factory setting.

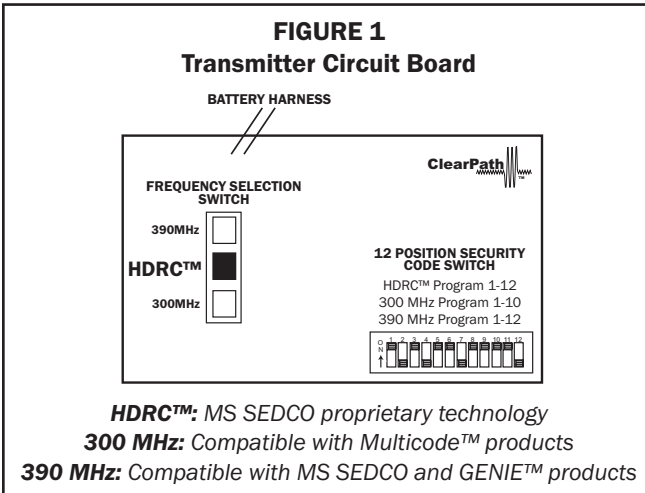

- 3) **SELECT SECURITY CODE:** Program the desired security code, via the 12 dip switches on the transmitter circuit board (Fig. 1).
- 4) If weatherproof gasket (#10001) is to be installed, apply per instruction provided with gasket.
- 5) Secure the door activator switch assembly (purchased separately) to the mounting box frame with the 6-32 screws provided with the switch.



**NOTE:** Drill out pilot holes in the mounting box frame when necessary to mount door activator switch.

- 6) Plug the 2-lead transmitter wiring harness onto the "COM" (Common) and "N.O." (Normally Open) contacts located on the door activator's microswitch.
- 7) Attach the box frame assembly with door activator switch to the back plate already mounted in its intended location (step 1) by placing the "lock lip" of the frame over the top of the back plate and then pushing it downward in a hinge-like motion (Fig. 2).
- 8) Secure the box frame to its back plate at the underside with the 1/4-20 screw supplied (Fig. 2).

**FIGURE 2**

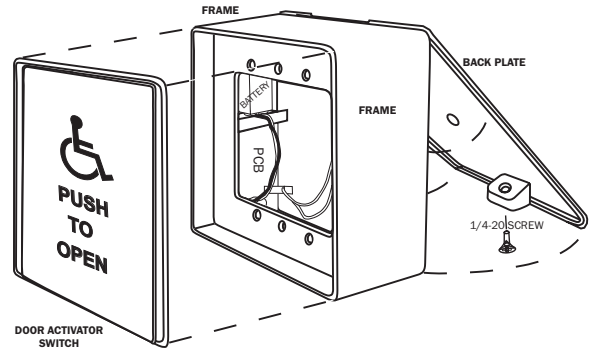

(Front View-Mounting Box Only)

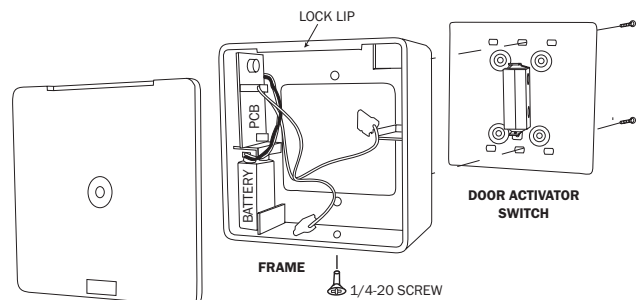

(Rear View)



**NOTICE:** This device complies with Part 15 of the FCC rules. Operation of this device is subject to the following two conditions: 1) This device may not cause harmful interference and 2) This device must accept any interference received, including interference that may cause undesired operation. Any changes or modifications not expressly approved by MS SEDCO could void the user's authority to operate this equipment.