



PULLING ACCESSORIES

Pulling Grips

Current Tools cable grips are hand-woven by experienced trades people and this guarantees a consistent level of high quality. **Current Tools** grips are reverse woven, creating a loop at the end of the grip instead of being soldered or crimped together.

The looped pulling head is actually a separate wire rope eye which is placed inside the swage sleeve along with the wire mesh strands. The swage sleeve is then crimped forming an extremely effective anchor point for both the looped head and the wire mesh. Testing proves this is never the weakest link of the product. The flexible eye allows cable to be pulled more easily through smaller conduit.

The **Current Tools** cable grips enclose the cable firmly over the entire length of the mesh. They are made of high tensile steel strands. Depending on the type of grip, the strand comprises 7, 12 or 19 wires. By selecting the most suitable strand, the tension distribution characteristics can be adjusted to suit the requirements.

All **Current Tools** grips meet the highest standards in terms of material and workmanship and we are pleased to offer a wide range of grips with different designs and eye arrangements for onsite, underground or overhead installations.

In addition to the grips listed in this catalog, **Current Tools** can also supply special products for particular fields of application. Information on these will be supplied upon request.

Some of the grips offered in this catalog have Rotating Heads which allow the grip to rotate while not under load.



Current Tools also offers the 00501 Series swivel, designed specifically for use with flexible eye grips, it is easily interchangeable but it will also not rotate under load.

All capacities indicated are Approximate Breaking Strength. Each user must decide what safety factor they require for each specific operation before selecting which grip to use. Due to metal fatigue and possible in-use damage, quoted values only apply to new grips.

Please refer to the following pages for information on **Current Tools** pulling grips. Line Swivels, Breakaway Swivels and Connectors suitable for use with the grips may also be found in this catalog.

Grip Selection Chart — For cables of equal diameter in one grip.

2 Cables Dia. Range ea Cable (in)	3 Cables Dia. Range ea Cable (in)	4 Cables Dia. Range ea Cable (in)	5 Cables Dia. Range ea Cable (in)	6&7 Cables Dia. Range ea Cable (in)	8 Cables Dia. Range ea Cable (in)	9 Cables Dia. Range ea Cable (in)	Required Grip Diameter Range
.30-.38	.25-.31	.22-.27	.19-.24	.17-.22	.15-.19	.14-.18	.50-.61
.38-.44	.31-.36	.27-.31	.24-.29	.22-.26	.19-.23	.18-.21	.62-.74
.44-.59	.36-.49	.31-.42	.29-.38	.26-.34	.23-.31	.21-.28	.75-.99
.59-.75	.49-.63	.42-.54	.38-.48	.34-.43	.31-.39	.28-.35	1.00-1.24
.75-.90	.63-.76	.54-.65	.48-.58	.43-.52	.39-.46	.35-.42	1.25-1.49
.90-1.07	.76-.89	.65-.77	.58-.67	.52-.60	.46-.54	.42-.49	1.50-1.74
1.07-1.22	.89-1.02	.77-.88	.67-.77	.60-.69	.54-.62	.49-.56	1.75-1.99
1.22-1.53	1.02-1.28	.88-1.10	.77-.96	.69-.86	.62-.77	.56-.71	2.00-2.49
1.53-1.83	1.28-1.53	1.10-1.32	.96-1.16	.86-1.03	.77-.93	.71-.85	2.50-2.99
1.83-2.14	1.53-1.79	1.32-1.54	1.16-1.35	1.03-1.20	.93-1.08	.85-.99	3.00-3.49
2.14-2.44	1.79-2.05	1.54-1.76	1.35-1.54	1.20-1.37	1.08-1.24	.99-1.13	3.50-3.99
2.44-2.75	2.05-2.30	1.76-1.98	1.54-1.74	1.37-1.55	1.24-1.39	1.13-1.27	4.00-4.49
2.75-3.06	2.30-2.56	1.98-2.20	1.74-1.93	1.55-1.72	1.39-1.55	1.27-1.41	4.50-4.99



Current Tools
FOR THE PROFESSIONAL ELECTRICIAN

www.currenttools.com

P.O. Box 17026 • Greenville, SC 29606 • 864.244.1201 • fax 864.244.5860 • 800.230.5421



Pulling Grips — 00661 Series

SINGLE WEAVE – GALVANIZED WIRE – SINGLE EYE – LIGHT DUTY

These grips offer a Flexible Eye with Single Weave galvanized wire construction for light duty applications.

Catalog Number	Size Range	Mesh Length	Approx. Breaking Strength	Weight
00661-004	0.15" to 0.24"	6 1/2"	400 lbs.	0.1 lb.
00661-006	0.25" to 0.37"	6 1/2"	460 lbs.	0.2 lb.
00661-010	0.38" to 0.49"	7 1/2"	860 lb.	0.3 lb.
00661-013	0.50" to 0.62"	9"	1,250 lbs.	0.4 lb.
00661-016	0.63" to 0.74"	12"	1,790 lbs.	0.8 lb.
00661-019	0.75" to 0.99"	12"	2,580 lbs.	1.2 lbs.
00661-025	1.00" to 1.24"	12"	4,090 lbs.	2.1 lbs.



Pulling Grips — 00662 & 00664 Series

NON CONDUCTIVE – SINGLE/DOUBLE WEAVE – SINGLE EYE

These grips are non-conductive and may be used to install fiber optic cable. Smaller sizes are Single Weave and larger sizes are Double Weave.

Catalog Number	Size Range	Weave	Approx. Breaking Strength	Weight
00662-010	0.38" to 0.74"	Single	2,500 lbs.	0.2 lb.
00662-020	0.75" to 1.12"	Single	3,700 lbs.	0.2 lb.
00664-030	1.13" to 1.49"	Double	9,800 lbs.	0.3 lb.
00664-040	1.50" to 1.99"	Double	11,800 lbs.	0.4 lb.



Pulling Grips — 00670 & 00671 Series

DOUBLE WEAVE – GALVANIZED WIRE – SINGLE EYE

These grips offer a Flexible Eye and Double Weave galvanized wire construction for regular load pulls.

Catalog Number	Size Range	Mesh Length	Approx. Breaking Strength	Weight
00670-025	0.24" to 0.37"	18"	4,250 lbs.	0.3 lb.
00670-038	0.38" to 0.74"	18"	5,000 lbs.	0.3 lb.
00670-050	0.75" to 1.12"	18"	6,600 lbs.	0.4 lb.
00670-100	1.13" to 1.49"	21"	10,000 lbs.	0.6 lb.
00670-125	1.50" to 1.99"	23"	13,800 lbs.	1.3 lbs.
00670-200	2.00" to 2.49"	24"	14,200 lbs.	1.4 lbs.
00670-250	2.50" to 2.99"	28"	17,500 lbs.	1.7 lbs.
00671-080	3.00" to 3.74"	30"	18,000 lbs.	1.9 lbs.
00671-095	3.75" to 4.24"	32"	26,500 lbs.	2.3 lbs.



Always read Breaking Strength, safety and technical data information.



PULLING ACCESSORIES

Pulling Grips — 00674 & 00675 Series

DOUBLE WEAVE – SINGLE EYE – SLACK GRIP – CLOSED MESH

These grips offer a Flexible Eye and Double Weave galvanized wire construction for those times when a side loaded pulling rope is easier. If the cable end is available, then the Closed Mesh is preferred.

Catalog Number	Size Range	Mesh Length	Approx. Breaking Strength	Weight
00674-010	0.38" to 0.74"	14"	2,500 lbs.	0.44 lb.
00674-020	0.75" to 1.12"	17"	3,000 lbs.	0.48 lb.
00674-030	1.13" to 1.49"	18"	5,000 lbs.	0.84 lb.
00674-040	1.50" to 1.99"	20"	10,000 lbs.	1.41 lbs.
00675-050	2.00" to 2.49"	21"	11,000 lbs.	2.56 lbs.
00675-065	2.50" to 2.99"	22"	12,000 lbs.	2.64 lbs.
00675-080	3.00" to 3.74"	23"	15,000 lbs.	2.95 lbs.
00675-095	3.75" to 4.24"	24"	15,000 lbs.	4.63 lbs.



Pulling Grips — 00678 & 00679 Series

DOUBLE WEAVE – SINGLE EYE – SLACK GRIP – SPLIT MESH (Lace-Up)

These grips offer a Flexible Eye and Double Weave galvanized wire construction for those times when a side loaded pulling rope is easier. If the cable end is not available, then the Split Mesh is preferred.

Catalog Number	Size Range	Mesh Length	Approx. Breaking Strength	Weight
00678-010	0.38" to 0.74"	14"	4,100 lbs.	0.44 lb.
00678-020	0.75" to 1.12"	17"	4,970 lbs.	0.55 lb.
00678-030	1.13" to 1.49"	18"	8,150 lbs.	0.82 lb.
00678-040	1.50" to 1.99"	20"	12,100 lbs.	1.39 lbs.
00679-050	2.00" to 2.49"	21"	16,140 lbs.	1.92 lbs.
00679-065	2.50" to 2.99"	22"	16,140 lbs.	2.00 lbs.
00679-080	3.00" to 3.74"	23"	20,170 lbs.	2.20 lbs.
00679-095	3.75" to 4.24"	24"	23,400 lbs.	3.09 lbs.



Always read Breaking Strength, safety and technical data information.



Current Tools
FOR THE PROFESSIONAL ELECTRICIAN

www.currenttools.com

P.O. Box 17026 • Greenville, SC 29606 • 864.244.1201 • fax 864.244.5860 • 800.230.5421



Pulling Grips — 00680 Series

DOUBLE WEAVE – SINGLE EYE – SHOULDERS

These grips offer a FLEXible Eye with Shoulders and Double Weave galvanized wire construction. The shoulders offer added protection to the cable being pulled in as well as protecting the leading wire strands.

Catalog Number	Size Range	Mesh Length	Approx. Breaking Strength	Weight
00680-025	0.25" to 0.49"	18"	4,800 lbs.	0.4 lb.
00680-038	0.50" to 0.74"	24"	5,800 lbs.	0.4 lb.
00680-050	0.75" to 1.12"	24"	6,700 lbs.	0.5 lb.
00680-100	1.13" to 1.49"	24"	10,000 lbs.	0.6 lb.
00680-125	1.50" to 1.99"	24"	16,400 lbs.	1.3 lbs.
00680-200	2.00" to 2.49"	24"	18,500 lbs.	1.5 lbs.
00680-250	2.50" to 2.99"	36"	24,500 lbs.	2.5 lbs.
00680-300	3.00" to 3.74"	36"	24,500 lbs.	2.7 lbs.
00680-350	3.75" to 4.24"	42"	31,000 lbs.	4.2 lbs.
00680-400	4.25" to 4.99"	48"	31,000 lbs.	4.9 lbs.



Pulling Grips — 00681 Series

TRIPLE WEAVE – SINGLE EYE – SHOULDERS

These grips offer a Flexible Eye with Shoulders and Triple Weave galvanized wire construction. The shoulders help to protect the leading edge of the cable and this type should be used for heavy duty applications.

Catalog Number	Size Range	Mesh Length	Approx. Breaking Strength	Weight
00681-006	0.25" to 0.49"	28"	6,500 lb.	0.5 lb.
00681-012	0.50" to 0.74"	33"	10,400 lb.	0.9 lb.
00681-019	0.75" to 0.99"	41"	16,000 lb.	1.8 lbs.
00681-025	1.00" to 1.24"	51"	25,400 lb.	3.1 lbs.
00681-032	1.25" to 1.49"	60"	31,700 lb.	4.0 lbs.
00681-038	1.50" to 1.99"	70"	32,000 lb.	4.5 lbs.
00681-048	2.00" to 2.49"	75"	44,600 lb.	4.7 lbs.



Always read Breaking Strength, safety and technical data information.



PULLING ACCESSORIES

Pulling Grips — 00682 Series

TRIPLE WEAVE – ROTARY HEAD – SHOULDERS

These grips offer a Stainless Steel Rotary Head with Shoulders and Triple Weave galvanized wire construction. The shoulders help to protect the leading edge of the cable and this type should be used for heavy duty applications.

Note: The Rotating Head does not replace the use of a Line Swivel, Series 00505. There are no bearings to allow rotation under load and severe damage may occur to the cable being installed if this product is used without the correct swivel.



Catalog Number	Size Range	Mesh Length	A	B	C	D	Approx. Breaking Strength	Weight
00682-006	0.25" to 0.49"	28"	7/8"	5/16"	1/2"	2 3/4"	6,500 lbs.	1.5 lbs.
00682-012	0.50" to 0.74"	33"	1"	1/2"	9/16"	3 7/8"	10,400 lbs.	1.9 lbs.
00682-019	0.75" to 0.99"	41"	1"	1/2"	9/16"	3 7/8"	16,000 lbs.	3.2 lbs.
00682-025	1.00" to 1.24"	51"	1 3/8"	1/2"	11/16"	5 3/8"	25,400 lbs.	5.1 lbs.
00682-032	1.25" to 1.49"	60"	1 5/8"	9/16"	7/8"	6 1/8"	31,700 lbs.	6.0 lbs.
00682-038	1.50" to 1.99"	70"	1 7/8"	11/16"	1"	7 1/4"	32,000 lbs.	6.5 lbs.
00682-048	2.00" to 2.49"	75"	1 7/8"	11/16"	1"	7 1/4"	44,600 lbs.	6.7 lbs.

Pulling Grips — 00690 Series

DOUBLE WEAVE – ROTARY HEAD – SHOULDERS

These grips offer a Rotating Eye with Shoulders and Double Weave galvanized wire construction. The shoulders help to protect the leading edge of the cable and this type should be used for heavy duty applications.

Note: The Rotating Head does not replace the use of a Line Swivel. There are no bearings to allow rotation under load and severe damage may occur to the cable being installed if this product is used without the correct swivel.

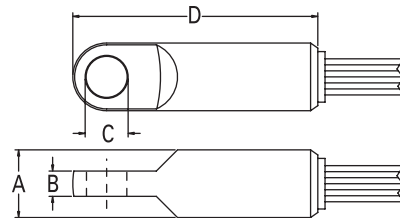

Catalog Number	Size Range	Mesh Length	A	B	C	D	Approx. Breaking Strength	Weight
00690-038	0.50" to 0.74"	16"	7/8"	5/16"	1/2"	2 3/4"	5,800 lbs.	1.5 lbs.
00690-050	0.75" to 1.12"	24"	7/8"	5/16"	1/2"	2 3/4"	6,700 lbs.	1.6 lbs.
00690-100	1.13" to 1.49"	33"	1 3/8"	1/2"	11/16"	5 3/8"	13,000 lbs.	1.9 lbs.
00690-125	1.50" to 1.99"	36"	1 3/8"	1/2"	11/16"	5 3/8"	16,500 lbs.	2.3 lbs.
00690-200	2.00" to 2.49"	36"	1 5/8"	9/16"	7/8"	6 1/8"	27,000 lbs.	3.8 lbs.
00690-250	2.50" to 2.99"	38"	1 7/8"	11/16"	1"	7 1/4"	33,000 lbs.	5.0 lbs.
00690-300	3.00" to 3.74"	39"	1 7/8"	11/16"	1"	7 1/4"	41,000 lbs.	5.2 lbs.
00690-350	3.75" to 4.24"	42"	1-7/8"	11/16"	1"	7 1/4"	48,000 lbs.	9.2 lbs.
00690-400	4.25" to 4.99"	58"	1-7/8"	11/16"	1"	7 1/4"	48,000 lbs.	9.9 lbs.

Always read Breaking Strength, safety and technical data information.



Current Tools
FOR THE PROFESSIONAL ELECTRICIAN

www.currenttools.com

P.O. Box 17026 • Greenville, SC 29606 • 864.244.1201 • fax 864.244.5860 • 800.230.5421



Pulling Grips — 00695 Series

DUAL WIRE – DOUBLE WEAVE – HIGH STRENGTH – SHOULDERS

These extra high strength grips feature a dual wire, double woven construction. This type of grip should be used for heavy duty applications such as overhead transmission wire. The grips are particularly suited to bare conductor and synthetic rope applications.



Catalog Number	Conductor Size Range	Rope Size Range	Mesh Length	Head Length	Approx. Breaking Strength	Weight
00695-019	0.19" to 0.37"	0.25" to 0.65"	24"	10"	6,800 lb.	1.0 lb.
00695-038	0.38" to 0.62"	0.50" to 0.90"	36"	12"	14,500 lb.	1.5 lbs.
00695-063	0.63" to 0.87"	0.75" to 1.10"	48"	13"	21,500 lb.	3.0 lbs.
00695-088	0.88" to 1.12"	1.00" to 1.50"	60"	15"	32,000 lb.	6.0 lbs.
00695-113	1.13" to 1.37"	1.25" to 1.70"	76"	18"	48,000 lb.	13.5 lbs.
00695-138	1.38" to 1.90"	1.50" to 2.10"	89"	24"	68,000 lb.	21.0 lbs.

Always read Breaking Strength, safety and technical data information.

Lube Spreader — 00510 Series

This product is designed to spread the lubricant around the walls and along the length of the conduit, while also acting as a connector.

The body is constructed out of Stainless Steel and the polyurethane disc has angular grooves which allow better distribution of lubricant.



Table A: Spreader Disc

Spreader Disc Catalog Number	Conduit Size	Disc Diameter	Connector Body	Weight
00515-200	2"	1 7/8"	00510-025	0.045 lb.
00515-250	2 1/2"	2 3/16"	00510-025	0.066 lb.
00515-300	3"	2 13/16"	00510-025	0.110 lb.
00515-350	3 1/2"	3 1/4"	00510-035	0.170 lb.
00515-400	4"	3 3/4"	00510-035	0.240 lb.
00515-500	5"	4 11/16"	00510-035	0.450 lb.
00515-640	6"	5 13/16"	00510-035	0.670 lb.

How to Order:

1. Select disc from table (A) to fit the internal diameter of conduit to be lubricated.
2. Select connector assembly from table (B) to match selected disc from table (A).

Table B: Connector Body

Connector Catalog Number	*Safe Working Load	Body Diameter	Overall Length	Clevis Pin	Weight
00510-025	4,000 lbs.	1 3/8"	4 5/8"	00025-HEX	0.70 lb.
00510-035	7,200 lbs.	2"	6 1/4"	00035-HEX	2.50 lbs.

*Safety Factor of 3:1